

General information and product instructions for use of sockets, fixing rings, manhole base liners, spillway heads, vortex shafts, channels and other sewerage elements for non-pressure sewerage systems

General

These product instructions are based on the applicable legal regulations and regulate the relationship between BENTEX-Plast s.r.o. (the supplier) and its customers. It describes how the customer must handle the delivered goods. Failure to follow the installation instructions may result in damage or malfunction of the goods, which entitles the supplier to reject complaints. By confirming the order and accepting the goods, the customer agrees to these product instructions.

General description of the products

Sockets, fixing rings, manhole base liners, spillway heads, vortex shafts, channels and other sewerage elements for non-pressure sewerage BENTEX Plast sewer systems (hereinafter referred to as the product) ensure a secure and watertight connection of the non-pressure sewerage, which guarantees trouble-free and optimum gravity drainage of the various types of wastewater.

Products receipt

The customer must properly inspect the products upon delivery. (according to common laws / consumer protection laws etc.). This includes in particular a physical inspection of the delivered products.

If there are any complaints, e.g. incorrect labelling, deviations in quantity or damaged packaging, these must be reported immediately upon receipt of the products.

A comprehensive complaint report must be drawn up directly and communicated to the supplier without delay.

Handling and storage of the products

Only store the products in accordance with the generally applicable conditions for the storage of plastic / laminate pipes and fittings in a covered, dry warehouse protected from the sun.

Never store the products upright in order to avoid possible ovality.

Stacking of loose products is permitted up to a maximum of three units. Particular attention must be paid to the weight of the products in order to avoid deformation or damage to the products.

If the products are stored in excessively high or heavy stacked columns, surface, strength or even shape damage may occur.

The products must not come into contact with sharp objects, chemicals, etc.

When stored in winter, low storage temperatures can cause the products to become brittle and thus damaged during use or assembly.

The recommended minimum product temperature for installation is 5 °C.

Products inspection before use/assembly

Before using / installing the product, check that the product is undamaged and in perfect condition.

There must be no impurities or defects on the surfaces in contact with water that could lead to defective or leaking connections later on. In the case of sockets with rubber seals, the condition of the seal must always be checked (cleanliness, labelling, type, dimensions, connection in the case of a bonded seal, etc.).

Installation instructions

The relevant applicable standards and installation guidelines must always be observed when installing the product.

We would particularly like to draw your attention to the following installation situations:

- If a shortened (cut) pipe is used, a chamfer of at least 15° must be applied and the sharp edges deburred.
- For pipes with profiled walls, the pipe end must be adapted so that the seal between the ribs is located in the first third of the active sealing surface of the sockets.
- Due to the requirements for the installation of the manhole base liners, the depth of the sealing diameter is reduced in some cases. A modification of the pipe is therefore necessary. When installing pipes with profiled walls where the depth of the gasket diameter is insufficient, the gasket ring must be inserted behind the first rib and cut off at the specified point (see Fig. No. 1). One gasket is sufficient to ensure tightness.

Fig. No. 1

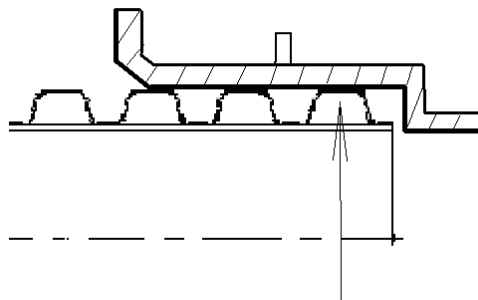

- Please note the compatibility of the pipes and BENTEX-Plast sockets to be used
- When using PUR foam to seal joints, it is essential to consult the PUR foam manufacturer to determine whether it is suitable for the respective application.
- Only use approved lubricants for rubber seals.
Do not use any unauthorised oils/greases etc.!
- For goods supplied with a seal, only use the seal supplied.
- Before commissioning the sewerage, a leak test must be carried out in accordance with the applicable regulations.

Processing (concreting) of sockets/manhole base liners

The sockets and manhole base liners are concreted in a mould with the corresponding or required diameter.

When concreting (connecting sockets from DN 200, channels from DN 300, berms continuous), suitable support and reinforcement materials must be used

These must be installed before concreting and must not be removed before the concrete has set.

This prevents undesirable deformation of the sockets / manhole base liners.

During the production process, no vibrating equipment (manual or automatic) may come into contact with the manhole base liners or the sockets.

Damage, leaks or deformations caused by non-compliance with the correct concreting procedure cannot be claimed.

Permitted repairs

Technological procedures as well as repair methods and material used for a required repair (to be decided on a case-by-case basis) must be authorised by the responsible employee of the supplier.

The repairs may only be carried out by an employee of the supplier or by a properly instructed and authorised employee.

- In general, the repair must be carried out in such a way that there are no dimensional changes to the product that could lead to leaks in the connection or make the connection of individual components (e.g. socket/pipes) completely impossible.
- General methods of surface repair (applies to GRP articles)
only polyester material may be used for surface sealing,
polyester topcoat is preferable for the protective layer. Visible brush strokes are permitted!
- Before delivery, the tightness of the connection must be checked (if the surface defect has been repaired in the area of sealing surfaces)

The manufacturer BENTEX-Plast s.r.o. is not liable for

- Tolerances and tightness of the connections in the event of non-compliance with the generally applicable principles for handling, laying, guiding and fastening pipes and applicable standards and installation regulations.
- The individual production conditions and tolerances of the individual concrete plant manufacturers. These conditions/tolerances must be agreed in advance with the concrete plant manufacturer.
- Deformation of manhole sockets / manhole base liners due to settlement, pressure and vibration loads during and after installation on the construction site.

In Borovany, 24th of September 2024

Ing. František Fošum, Managing Director



These product instructions do not cover all possible production and installation conditions.

If you have any further questions, please contact your local concrete plant directly.

The depth of the sockets was determined on the basis of customer requirements.